

We recommend consulting a professional if you are unfamiliar with installing hardware fixtures.

1. Mark the position for the fixing hole on the door.
2. Using a **8mm drill bit**, carefully drill straight through the door at selected position.
3. With the threaded bar threaded into the knob, insert the threaded bar and fit the square base of the knob into the rose. Then, with the rose flat against the door, push the threaded bar through the 8mm hole, ensuring there's enough protrusion to fit the washer and then to thread the nut on the inside of the door.
4. Using an appropriate spanner, tighten nut on inside of the door and ensure the whole assembly is secure.

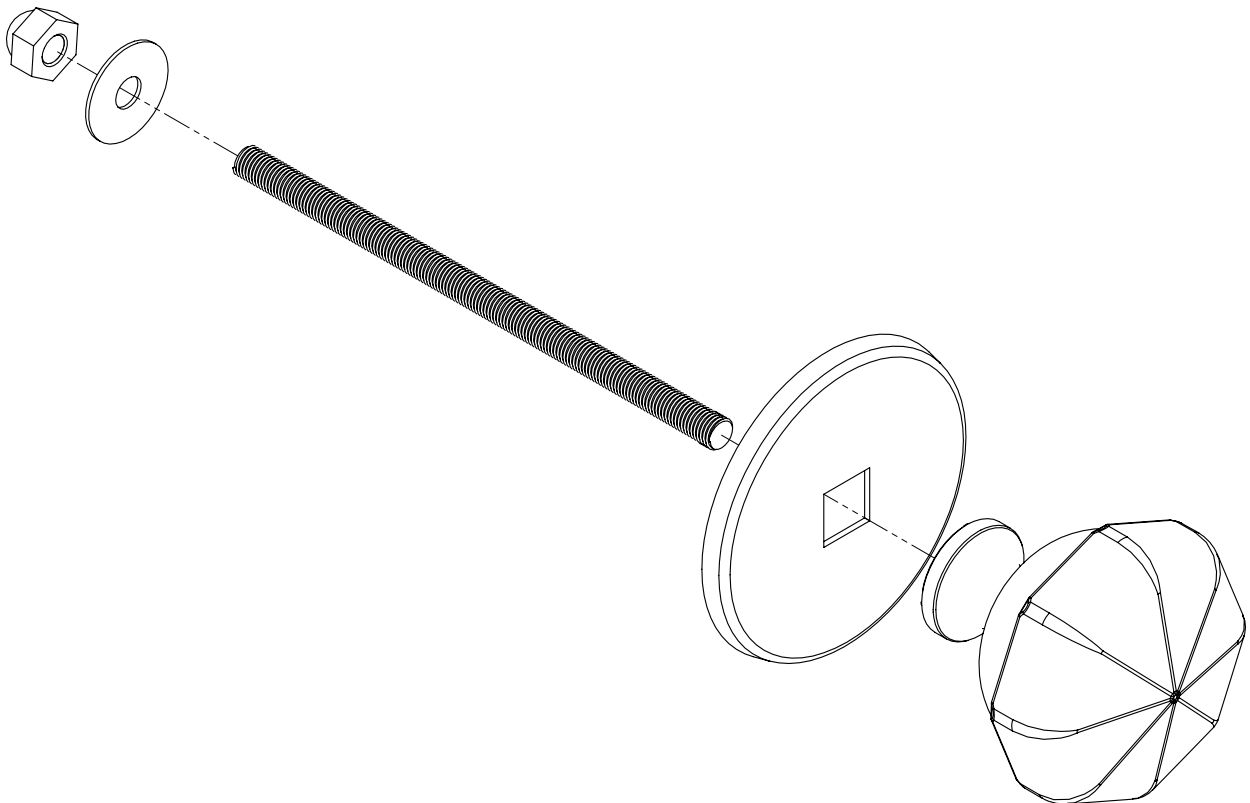

Drawings are not to scale.

FITCB0091 | Revision A