

Enduromax Grade 14 Thrust Bearing Hinge

H2N1121/14SSS

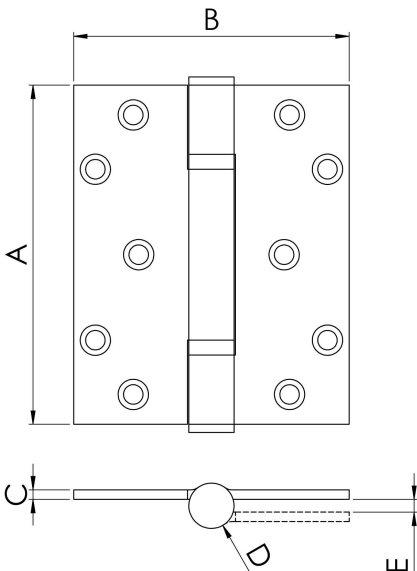

Grade 14 Thrust Bearing Hinge, Square (Max Load 160kg)
 Non removable pin. These are usually specified in heavy use commercial developments such as schools, hospitals, airports, public buildings. They carry a CE mark and are Certifire tested. BS EN 1935 rated.

