

## Roller Arm Stay

### Product Images

---



### Description

---

The roller arm stay is used to restrict the opening of light to medium weight bottom hung fan light windows and side hung windows. Fitted with a brass

roller ensuring longevity in service unlike the cheaper plastic rollers. The roller is plated to match the arm finish. The stay can be used individually or in pairs depending on width of window. Rollers hang vertically when the window is closed. These products are not handed. Comes with a 10 year mechanical guarantee. Extended version available.

## Technical Details

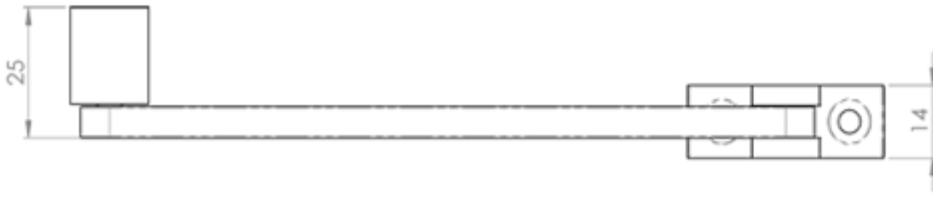

CARLISLE BRASS

DK8

This drawing is the property of Carlisle Brass Limited, all design rights reserved

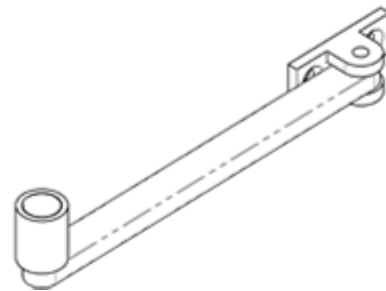

## Specification



## Additional Information

SKU	DK8 Range
Brands	Carlisle Brass
Technical	4
Line Drawings	DK8.PDF

## Product Options

---

Finishes:	Polished Chrome
	Satin Chrome
	Polished Brass
Options:	Standard Roller
Sizes:	157mm