

Double Steel Washered Brass Butt Hinge

HDSW

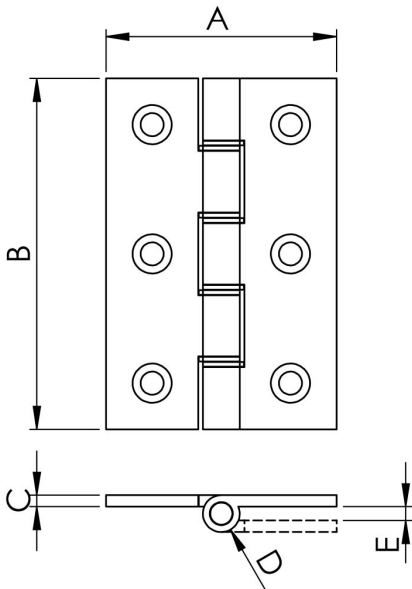

A solid brass, steel washered butt hinge, ideal for internal doors of light to medium weight. The Butt Hinge is often considered more appropriate in residential properties due to the size of the hinge knuckle being smaller and more discreet than the knuckle on ball bearing hinges. Suitable for standard internal residential doors a pair of hinges is adequate; however fitting 3 hinges per door has its advantages. It will look aesthetically pleasing and from a practical viewpoint it helps spread the load evenly and will help to overcome twisting or warping.

