

Hand Forged Pewter Shepherds Crook Locking Casement Fastener

Product Images



Description

An individually hand forged, locking window fastener using traditional blacksmith methods. Left or Right hand options. The fastener is so called because of the elegant shepherds crook swirl at the bottom of the lever. Can be used in conjunction with the shepherds crook casement stay to achieve a consistent appearance. The rustic old fashioned styling is more suitable for period properties. To create this unique finish, it is electro plated and then stove lacquered making it extremely durable both internally and externally. If a natural metal look with a virtually maintenance free finish is required, then this pewter effect is the logical choice. Comes with a 10 year mechanical guarantee.

Technical Details

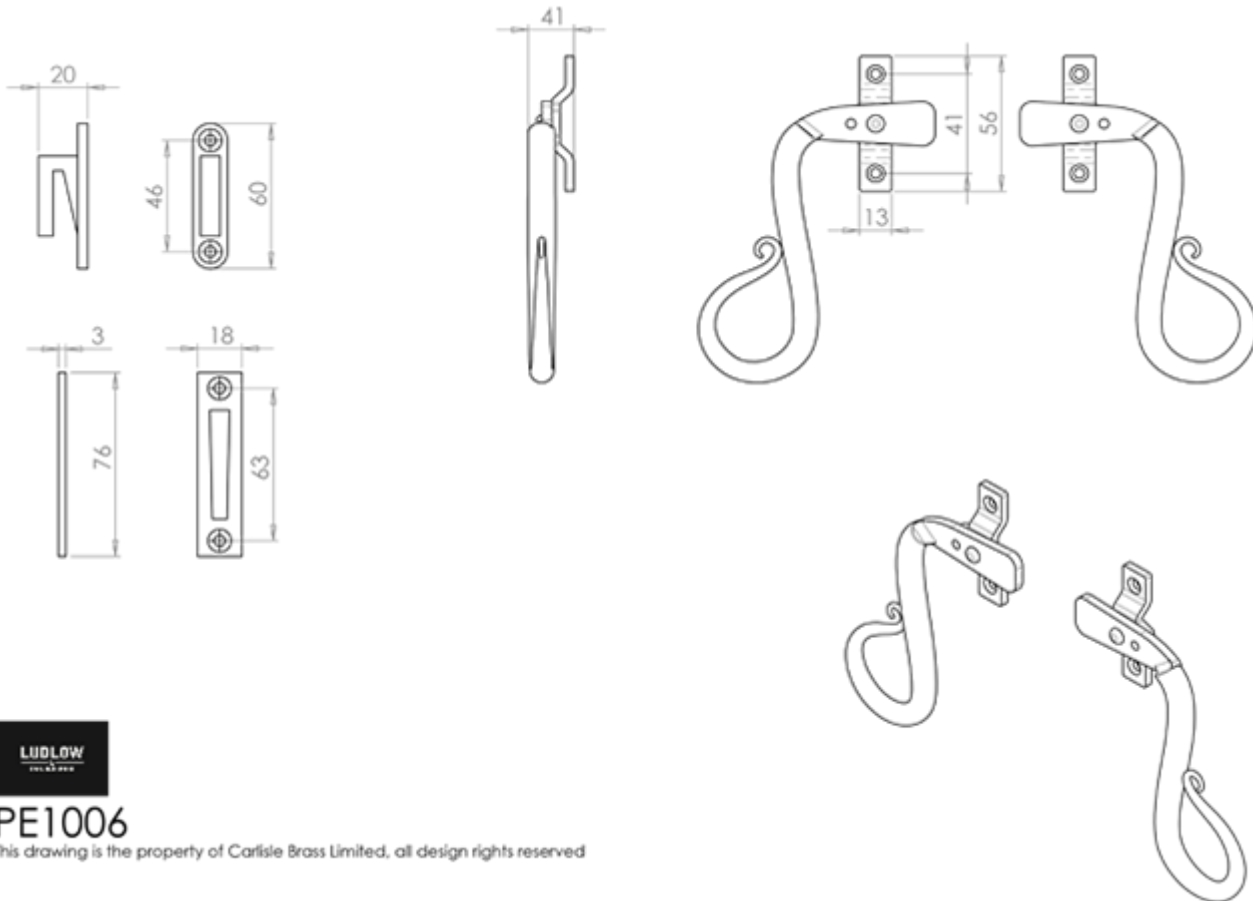

PE1006

This drawing is the property of Carlisle Brass Limited, all design rights reserved

Specification



Additional Information

SKU	PE1006
Brands	Ludlow Foundries
Technical	4
Line Drawings	PE1006.PDF

Product Options

Finishes:	Pewter Effect
Options:	Left Hand
	Right Hand
Sizes:	56mm x 13mm